

# SUPERSEDED

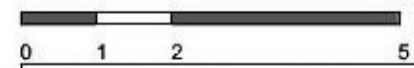

9 CROSS SECTION 9



Revision	Date	Notes
A	30/11/12	Stage D GA Sections
B	08/01/13	Ground Level Raised and Amended to match all Stage D information.
C	15/02/13	Amended to draft planning submission.
D	18/03/13	Detailed Planning Submission

Notes		
1. Bath Stone	8. Rimex Stainless Steel Roof Tiles	15. Recessed Solar Panels
2. Brick	9. PPC Aluminium Ventilation Grill	16. Existing Retained Facade
3. Composite Double Glazed Windows	10. PPC Aluminium Panel	17. Oak Gate with Inset Door
4. Champagne 200mm Reveals	11. Stainless Steel Window System with Door	18. Anodized Aluminium Cladding
5. Frameless Fixed Glazing	12. Aluminium Framed Glazing	19. Double Glazed Dormer
6. PPC Aluminium Cappings	13. Aluminium Framed Glazed Door	20. Glass Balustrade
7. PPC Aluminium Gutter Detail	14. Metal Gate	21. Frameless Glass between Timber Fins

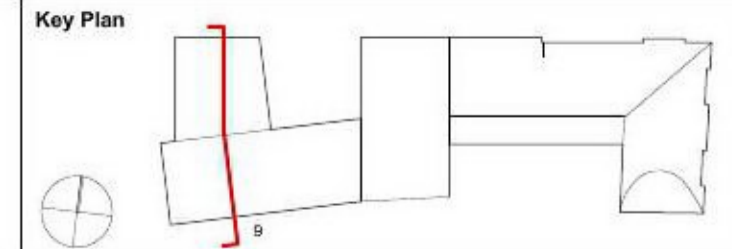

1. Do not scale drawings. All dimensions to be checked on site. Errors to be reported to architect. To be read in conjunction with all relevant architects services and engineers drawings.  
 2. Contractors, sub-contractors and suppliers to verify any critical dimensions on site prior to fabrication of any building element. Any discrepancies to be reported to the architect.  
 3. This drawing to be read in conjunction with all relevant specifications, engineers and specialists consultative information and any discrepancies reported prior to installation.



Project	: EXETER COLLEGE WALTON STREET QUAD
Title	: PROPOSED SECTION 09
Client	: EXETER COLLEGE
Scale	: A3 - 1:200 : A1 - 1:100
Date	: 18.03.13
Drawing	: 2344_A305